

FREE!
Volume 10, Issue 3

MOAB AREA

real estate

APRIL–MAY 2026

MAGAZINE



Moab's marvelous public art
Take a stroll downtown to view the sculpture exhibition

Also inside... The area's most complete real estate listings | A passion for Moab's history



Country living bliss on 70 acres

MLS#2116649 | \$1,430,800

Berkshire Hathaway HomeServices (See page 2)

Exclusive golf course living

MLS#2107448 | \$1,295,000

Wells Land & Real Estate (See page 38)

Castle Valley artist's home

MLS#2140394 | \$990,000

eXp Realty (See page 21)

Kim Kirks
REALTOR®



338 TAYLOR LANE, CASTLE VALLEY
2 BED | 1 BA | 2,312 SF | 5.74 AC
\$700,000 | MLS 2140375



343 TAYLOR LANE, CASTLE VALLEY
7.2 AC
\$350,000 | MLS 2132374



3135 N THOMPSON CYN RD
3 BED | 2 BA | 1,179 SF | 70.24 AC
\$1,430,800 | MLS 2116649

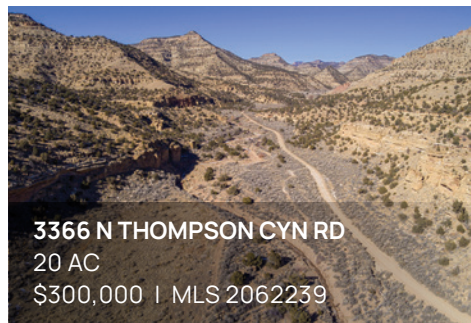

3366 N THOMPSON CYN RD
20 AC
\$300,000 | MLS 2062239



1479 S WEST KAYENTA DR
5.22 AC
\$344,900 | MLS 2120739

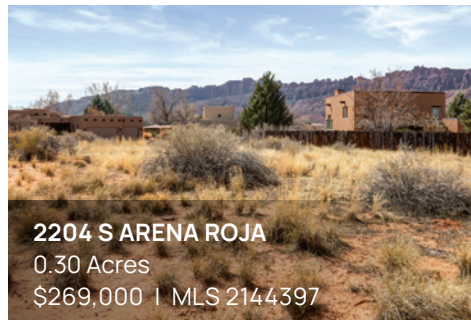

2204 S ARENA ROJA
0.30 Acres
\$269,000 | MLS 2144397

IF YOU ARE LOOKING
FOR A REALTOR,
TALK TO KIM.

"Too much to say so I will start with this. We loved working with Kim, Her professionalism, kindness, knowledge, attention to details, promptness, communication and HONESTY made working with her a pleasure. If you need a realtor with integrity, you need Kim Kirks."

– David L., Buyer

"Excellent job and a pleasure to work with Kim, she is highly skilled, experienced, and very proactive to sell for the best price and terms. She markets properties very well and is connected to wide audiences and links. She knows the market and business and went above and beyond."

– Renee, Seller



I've worn many hats—from wildland firefighter to property manager—but my true passion is helping people achieve their real estate goals while strengthening the Moab community one connection at a time. Whether you're buying your first home, a vacation retreat, or an investment property, I'll take the time to understand your vision and guide you at your pace. Let's connect and turn your goals into reality.

KIM KIRKS
REALTOR®

(801) 369-9184

kkirks@bhhsutah.com

📷 @moabhavenrealtor

Scan to View My Listings ▶



50 E Center Street | Moab, Utah

**BERKSHIRE
HATHAWAY**
HOMESERVICES

UTAH
PROPERTIES

Table of Contents

APRIL–MAY 2026



Moab's marvelous public sculptures16



A passion for Moab's history 32

Directory of Services46

Real Estate Listings:

Berkshire Hathaway HomeServices	2
eXp Realty	21
Moab Premier Properties	23
Summit Sotheby's International Realty	24
Realtypath (Moab)	30
Wells Land & Real Estate	38
Moab Realty	41

Publisher, Editor: **Andrew Mirrington**

Graphic design: **Kristal Franklin**

Advertising sales: **Andrew Mirrington**

Contributors: **Rachel Fixsen, Sharon Sullivan**

Photographer: **Murice D. Miller**

Contributing editor: **Julia Myers**

Proofreader: **John Mirrington**

Distribution: **Hand & Heart Services**

Bookkeeping: **Joanna Mirrington, Collette Coronella**

Printing: **Publication Printers**

Moab Area Real Estate Magazine

is published by **AJM Media, LLC**

P.O. Box 1328, Moab, UT 84532

(303) 817-7569

andrewmirrington@gmail.com

moabarealestatemagazine.com

Magazine cover:

Artist Steve Grater's steel sculpture "Evolving I" is part of the ArtTrails public art exhibit located throughout downtown Moab. [Photo by Bruce Hucko / Courtesy of Moab ArtTrails]

Top: Reven Marie Swanson's current Moab ArtTrails piece, at the corner of Center and Main streets, is titled "First Sign of Spring." [Photo by Murice D. Miller]

Bottom: History Moab's Blaine Reniger teaching "History 101" for local tour guides at the Moab Museum. [Courtesy photo]



LEXIE DALTON (801) 836-1450
MICHELLE STRONG (314) 309-8106
SHANNON MEREDITH (435) 260-7484
RACHEL MOODY (435) 260-8245
CORAH MOODY (435) 260-0255
MIKALA LAWLEY (435) 260-2936



RACHEL MOODY TEAM

WWW.MOABLIVING.COM

We are
COMMITTED TO YOU

Here at the Rachel Moody Team, we understand how important growth is... In a landscape like Moab, growth takes patience, resilience, and the right conditions to thrive. Real estate is no different.

We are committed to helping you make smart moves, build equity, and move forward with confidence.

We are committed to **your** growth.

f @MoabLiving



ESCAPE TO YOUR DESERT RESORT

100 S Joe Wilson Dr
5 BD | 4 BA | 5,118 SF | 5.25 AC + Guest House
\$2,450,000



STUNNING HOME IN PUESTA DEL SOL

2182 Salida Del Sol
5 BD | 3.5 BA | 3,716 SF | 0.40 AC
\$1,395,000



CONSERVANCY OASIS

2927 S East Bench Rd
3 BD | 2.5 BA | 1,851 SF | 10.74 AC
\$2,850,000



VALLEY OF THE ANCIENTS

1095 S Montezuma Canyon Rd
7 BD | 4 BA | 7,358 SF | 36.14 AC + Guest House
\$2,195,000



THE DESERT'S RIPARIAN SOUL

1389 Powerhouse Ln
2 BD | 1 BA | 1,159 SF | 24.76 AC + Guest House
\$4,995,000



NEW!

VIRTUALLY STAGED

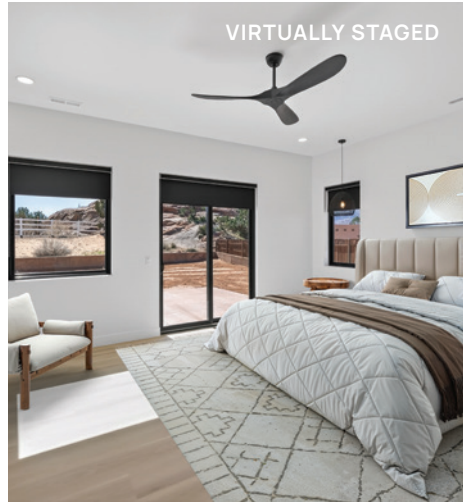

VIRTUALLY STAGED

STUNNING NEW BUILD

The layout has superior function, celebrating two master en-suites, two additional guest bedrooms with a full bath, and mudroom with laundry. Plenty of space for parking along with an attached 2-car garage with room for a sprinter van, as well as a third car garage with double roll up doors- for your toys or your entertaining room off the front patio!

2235 Salida Del Sol
4 BD | 3 BA | 3,141 SF | 0.40 AC
\$1,475,000



LUXURIOUS & SPACIOUS
Puesta Del Sol Community
2195 Salida Del Sol
3 BD | 3 BA | 2,860 SF | 0.36 AC
\$1,395,000



PRICE REDUCED!

SOPHISTICATED GETAWAY
Destination Escape for Adventure
1261 N Main Rubicon Trl R-1
3 BD | 2.5 BA | 2,944 SF | 0.32 AC w/ Resort Amenities
\$1,995,000



NEW!

PRIVATE GEM
Private Pool
2520 Willow Creek Rd
4 BD | 3.5 BA | 4,009 SF | 0.51 AC
\$1,390,000



EXCEPTIONAL VIEWS

Twin home with sweeping vistas of the La Sal Mountains and surrounding red rock, offering end of the road privacy. This uniquely designed two story home sits on 0.15 acres and features a two car garage along with warm, inviting finishes throughout. Outdoor living is a standout feature, with a gorgeous stone patio on the lower level and a spacious upper deck that spans the length of the home, perfect for taking in the surrounding scenery.

440 Mckay Place
 3 BD | 3 BA | 1,731 SF | 0.15 AC
 \$750,000



OLD TOWN CHARMER & RENTALS
 195 East 200 North
 3 BD | 3 BA | 1,593 SF | 2.03 AC | \$915,000



EXCEPTIONAL BALCONY LIVING
 443 W Kane Creek Blvd B214
 2 BD | 1 BA | 716 SF | \$365,000



LONG-RANGE VIEWS
 443 W Kane Creek Blvd B211
 1 BD + den | 1 BA | 700 SF | \$345,000



SMART AND EFFICIENT
 1185 S Murphy Ln 105D
 1 BD | 1 BA | 440 SF | \$240,000



TOP TIER VIEWS
 1185 S Murphy Ln 402B
 1 BD | 1 BA | 440 SF | \$280,000



VALLEY VIEWS
 1018 S Valley View Ct
 5 BD | 2.5 BA | 1,900 SF | 0.16 AC | \$775,000

©2026 BHH Affiliates, LLC. An independently owned and operated franchisee of BHH Affiliates, LLC. Berkshire Hathaway HomeServices and the Berkshire Hathaway HomeServices symbol are registered service marks of Columbia Insurance Company, a Berkshire Hathaway affiliate. Equal Housing Opportunity. Information not verified or guaranteed.*Closing cost credit is offered by the developer of Murphy Flats, Cottonwood Condos and Desert Sol Villas is subject to terms and conditions. Availability and eligibility not guaranteed. Berkshire Hathaway HomeServices Utah Properties is not affiliated with this promotion. Contact the Murphy Flats, Cottonwood Condos and Desert Sol Villas sales team for details



ONE-OF-A KIND CONTAINER HOME
 58 E Mt Peale Dr
 3 BD | 3 BA | 1,280 SF | 1.04 AC | \$750,000



BACK YARD BEAUTY
 480 Cottonwood Ln
 4 BD | 3 BA | 2,300 SF | 0.24 AC | \$745,000



OPPORTUNITY AWAITS
 230 North 500 West
 4 BD | 2 BA | 1,612 SF | 0.98 AC | \$1,200,000



COUGAR CANYON
 12343 Sand Flats Rd
 3 BD | 2.5 BA | 1,692 SF | 10.00 AC | \$892,000



WILSON ARCH COTTAGE
 10 Pioneer Dr
 2 BD | 1 BA | 920 SF | 0.33 AC | \$399,000



EQUESTRIAN'S DREAM
 9 Chamisa Ln - Castle Valley
 1 BD | 1 BA | 600 SF | 5.02 AC | \$545,000

COTTONWOOD CONDOS

\$7,500 Closing Cost Credit!*

214 S 200 E
 1-3 BD | 564-1,589 SF
 Starting at \$355,000



DESERT SOL VILLAS

Up to \$15,000 Closing Cost Credits!*

Desert Sol Ct
 4-6 BD | 2,041-2,700 SF
 Starting at \$703,000





ADVENTURE MEETS COMFORT

Fully furnished, this townhome is ideally positioned as a second home, primary residence, or income producing short-term rental. Located across the street, the community amenities include a seasonal pool, hot tub, and clubhouse. Whether you are looking for a personal retreat or a smart addition to your portfolio, this property delivers views, versatility, and location in one of Moab's most desirable settings.

3686 S Spanish Valley Dr M4
3 BD | 2 BA | 1,573 SF | \$697,000



VILLAGE CAMP RESORT LOTS
1261 N Main Rubicon Trl M-18 and M-19
0.08 AC | Buildable RV Lots
\$245,000-\$249,000



POOLSIDE AT ENTRADA
429 North 600 West
4 BD | 2.5 BA | 2,261 SF
\$974,900



PREMIER PORTAL VIEWS
673 West 470 North
4 BD | 2.5 BA | 2,261 SF
\$995,000



BACKYARD RETREAT
347 Williams Way
3 BD | 2 BA | 1,791 SF
\$795,000



RIM VILLAGE VISTAS 9A1
3862 Desert Willow Cir 9A1
3 BD | 2.5 BA | 1,520 SF
\$675,000



RIM VILLAGE W4
 3686 S Spanish Valley Dr W4
 3 BD | 2 BA | 1,551 SF | \$675,000



RIM VILLAGE N2
 3686 S Spanish Valley Dr N2
 3 BD | 2 BA | 1,551 SF | \$769,000



CASTILLO BY MOAB GOLF COURSE
 3418 E La Camino
 3 BD | 2 BA | 1,686 SF | \$625,000



AMAZING SETTING
 3414 E La Camino
 2 BD | 2 BA | 1,500 SF | \$599,000



ADORABLE SOLANO VALLEJO
 3246 E Fairway Loop
 2 BD | 2 BA | 1,160 SF | \$590,000



DREAM GETAWAY AT SOLANO VALLEJO
 3354 E Fairway Loop
 2 BD | 2 BA | 1,160 SF | \$565,000

RECREATE AT RIM VISTAS!

3862 S Desert Willow Cir 6A6
 3 BD | 2.5 BA | 1,562 SF
 \$675,000 | MLS 2138005



LIONBACK RESORT

A stone's throw from laid-back Moab.
 Furnished & move-in ready.
 Short-Term Rental Zoning.



RESORT POOL NOW OPEN





AMONG THE ROCKS
3529 E Arena Roja | Home Site
0.44 AC | \$289,000



WHITE HORSE LOT 18
4265 E Lipizzan Jump
0.50 AC | \$225,000



WHITE HORSE LOT 12
4152 E Shadowfax Run
0.50 AC | \$225,000



SPACIOUS BUILDING SITE
4690 Luna Cir | Home Site
1.43 AC | \$275,000



EQUESTRIAN'S DREAM
9 Chamisa Ln - Castle Valley
1 BD | 1 BA | 600 SF | 5.02 AC | \$545,000



ESCAPE TO CASTLE VALLEY
66 W Bailey Ln | Castle Valley
6.90 AC | \$350,000



THOMPSON SPRINGS LOT
68 N King St | Rural Residential Parcel
2.22 AC | \$149,000



WILSON ARCH RESIDENTIAL
32 W Austin Ct
1.32 AC | \$99,000



WILSON ARCH HOME LOT
49 W Ryan Ct
1.33 AC | \$89,000

HIGH DESERT BEAUTY
3239 Carroll Dr | Home Site
1.28 AC | \$275,000





NEW!

COMMERCIAL DEVELOPMENT
2302 Resource Blvd
2.34 AC | \$1,475,000



NEW!

DEVELOPMENT WITH STORAGE
67 South 100 West | Commercial Land
0.73 AC | \$1,100,000



LOCATION, LOCATION, LOCATION!
38 South 100 West | Commercial Land
1.02 AC | \$1,990,000



NEW!

MOAB BUSINESS PARK C1
11850 S Highway 191 C1
0.04 AC | \$360,000



COMMERCIAL LOT
656 West 400 North
0.37 AC | \$625,000



BUILD YOUR COMMUNITY
35 Acres West Coronado
35.03 AC | \$5,200,000



COMMERCIAL LODGING
1 Canyon Shadow Subdivision
4.67 AC | \$2,575,000



WILSON ARCH - PHASE 2
73 Parcels, Fully Platted & Engineered
147 AC | \$1,359,000



WILSON ARCH COMMERCIAL
1004 N Hwy 191 A
2.16 AC | \$163,000



WILSON ARCH COMMERCIAL
33 S Joe Wilson Dr E
5.68 AC | \$245,000



3492 E KERBY LANE

3 BD | 3 BA | 1,525 SF | 1.0 Acres
\$749,000 | MLS 2144868

Modern Ranch Living with Breathtaking Moab Vistas Experience the perfect blend of high-desert beauty and thoughtful interior design in this 3-bedroom, 2-bath ranch-style home located on a one acre lot. Flooded with natural light, the open-concept kitchen and living area serve as the heart of the home, designed specifically for easy gatherings and a seamless flow.

Angela Houghton (435) 260-0700



2610 LONG STREET, GREEN RIVER

72.63 Acres | Development Parcel or Farm
\$2,500,000 | MLS 2090339

Kim Kirks (801) 369-9184



2331 MESA RD. D-12 / 2331 MESA RD. D-5

3 BD | 2.5 BA | 1,610 SF | \$929,000 | MLS 2110349
3 BD | 2.5 BA | 1,610 SF | \$849,000 | MLS 2114864

Nikole Andersen (801) 750-5280



430 UTE CIRCLE

4 BD | 1 BA | 1,494 SF | 0.18 Acres
\$550,000 | MLS 2147679

Kerby Carlisle-Grant (720) 480-0890



276 OPAL AVE

3 BD | 2 BA | 1,125 SF | 0.17 Acres
\$525,000 | MLS 2107728

Kerby Carlisle-Grant (720) 480-0890



3853 S RED VALLEY CIRCLE #17-A4

2 BD | 2 BA | 1,380 SF
\$519,000 | MLS 2117422

Nikole Andersen (801) 750-5280



2511 REDCLIFF RD #3A

3 BD | 2 BA | 1,384 SF
\$496,000 | MLS 2140502

Angela Houghton (435) 260-0700



112 S COTTONTAIL AVE, LA SAL

39 Acres
\$425,000 | MLS 2108731

Angela Houghton (435) 260-0700



443 KANE CREEK BLVD. #B-301

2 BD | 1 BA | 716 SF
\$374,900 | MLS 2130451

Nikole Andersen (801) 750-5280



1479 S WEST KAYENTA DR

5.22 AC
\$344,900 | MLS 2120739

Kim Kirks (801) 369-9184





4 COUNTY ROAD 320, MONTICELLO
 2 BD | 2 BA | 1,767 SF
 \$548,600 | MLS 2123912

Janet Thomas (435) 760-0316

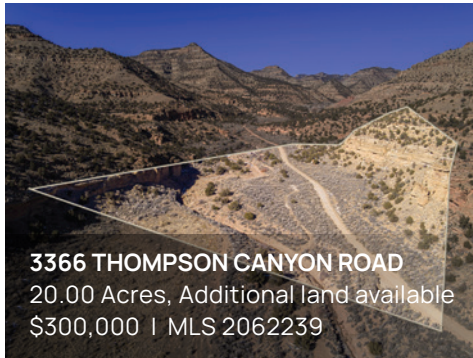

3366 THOMPSON CANYON ROAD
 20.00 Acres, Additional land available
 \$300,000 | MLS 2062239

Kim Kirks (801) 369-9184



2220 N LONG STREET, GREEN RIVER
 11.96 ACRES | A-1 ZONING
 \$250,000 | MLS 2090353

Kim Kirks (801) 369-9184



2204 S ARENA ROJA
 0.30 Acres
 \$269,000 | MLS 2144397

Kim Kirks (801) 369-9184



60 S WRAY MESA ROAD, LA SAL
 13.85 AC
 \$225,000 | MLS 2128682

Dominic Bauer (970) 312-1931

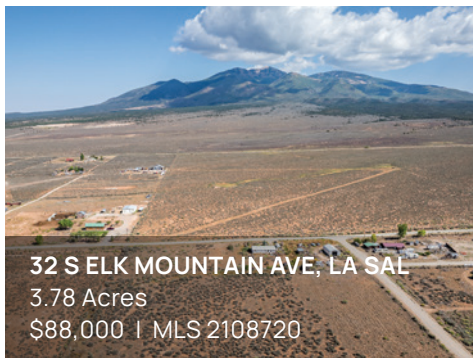

32 S ELK MOUNTAIN AVE, LA SAL
 3.78 Acres
 \$88,000 | MLS 2108720

Angela Houghton (435) 260-0700



225 N BOBBIE LANE, LA SAL
 1.01 Acres
 \$47,000 | MLS 2059391

Kim Kirks (801) 369-9184



Nikole Andersen
 (801) 750-5280
 NikoleAndersen@bhhsutah.com



Managing
 Broker



Angela Houghton REALTOR®
 (435) 260-0700
 AngelaH@bhhsutah.com



Kim Kirks REALTOR®
 (801) 369-9184
 KimKirks@bhhsutah.com



Kerby Carlisle-Grant
 (720) 480-0890
 Kerby.Grant@BHHSUtah.com



Janet Thomas REALTOR®
 (435) 760-0316
 Janet@bhhsutah.com



Taralyn Smith REALTOR®
 (435) 938-1552
 Taralyn@bhhsutah.com



Property
 Manager



Shauna Williams REALTOR®
 (641) 638-1157
 Shauna.Williams@bhhsutah.com



Dom Bauer REALTOR®
 (970) 312-1931
 dom.bauer@bhhsutah.com



**BERKSHIRE
 HATHAWAY**
 HOMESERVICES

**UTAH
 PROPERTIES**



THE BLAKE WALKER GROUP

THE BLAKE WALKER GROUP was founded by Heidi Blake and Landen Walker after years of working together in real estate. Today, the team includes seven experienced agents with more than 50 years of combined industry expertise. The group offers comprehensive services including investment property specialization, residential sales, licensed commercial representation, and long-term property management. As trusted local experts, the Blake Walker Group is your go-to real estate team for Moab and the surrounding areas.



Heidi Blake
435-260-8185



Landen Walker
435-260-2801



Kali Bisco
435-260-9906



Reina Every
435-260-1542



Jacque Gustafson
801-870-4228



Gina Giffin
303-419-1192

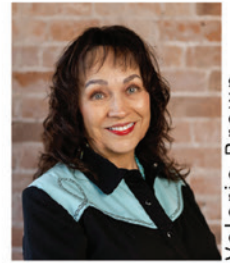

Valerie Brown
435-260-2808



111 West Abby Rd. Bluff, UT 84512
Valerie Brown, 435-260-2808



16 West Cobble Lane Bluff, UT 84512
Reina Every, 435-260-2808



248 South Hillside Drive Moab, UT 84532
Landen Walker, 435-260-2801



100 West 200 South Moab, UT 84532
Kali Bisco, 435-260-9906



4655/4693 Sunny Acres Moab, UT 84532
Heidi Blake, 435-260-8185



443 Kane Creek Blvd. #B-112
Jacque Gustafson, 801-870-4228

ADJACENT PROPERTIES



11830 S. Hwy. 191, Moab, UT
Kali Bisco, 435-260-9906



5401 S. Hwy. 191, Moab, UT
Gina Giffin, 303-419-1192

AGENT SPOTLIGHT
LANDEN WALKER
REALTOR 435-260-2801



MARKETING



HOME BUILDING & DESIGN

WIFE & MOM

OVER A DOZEN REAL ESTATE TRANSACTIONS AS A CONSUMER.
(CHANCES ARE, I'VE BEEN IN YOUR SHOES.)



YOUR PERSONAL
HYPE GIRL

MOAB'S *marvelous* PUBLIC ART

Take a stroll downtown to view
the Moab ArTTrails sculpture exhibition

By Sharon Sullivan

A stunning black serpentine stone sculpture, titled *Wise Spirit Medium*, appears to keep an eye on things from its perch at the corner of 100 East and 100 North in downtown Moab.

Artist Gedion Nyanhongo explains that the sculpture represents a spirit guide for the nation.

"In Zimbabwe we rely on the spirit medium to guide us; to know what to do," in the face of drought, disease, or other calamities, Nyanhongo says. "We need guidance; we always need guidance. They see before we see. We have to listen to our spirit, which is older than stones, older than mountains."

The sculpture is one of 14 featured in the current Moab ArTTrails exhibition, and was voted "Best in Show" during the unveiling of the 2025-26 public art exhibit – an annually rotating exhibition located two blocks east and west of Main Street.

Wise Spirit Medium is made from a dark-colored, exceptionally hard serpentine stone found in Zimbabwe. The top of the sculpture depicts an owl with eyes made of red jasper, a type of quartz known by ancient peoples for its protective properties, Nyanhongo says.

The installation of new sculptures is celebrated annually in October with an "Art-Stroll" – a community walking tour to visit

the dozen or so new artworks installed earlier that day. The artists themselves are also present for the tour, to visit with the community and answer questions about their work. Pedestrians – some dressed in costumes – are accompanied by music programmed by mobile DJ Pete Apicella – with input from Christy Williams Dunton, who, along with sculptor and partner Michael Ford Dunton, cofounded Moab ArTTrails.

Nyanhongo, who divides his time between Ohio and Arizona, described the day as family-like, saying it was "beautiful" to visit with community members, and fellow artists.

This is the fourth year that Denver, Colorado artist Reven Marie Swanson, has had her work selected for the yearlong exhibit. "The art stroll is a fabulous event," she says. "It feels like half the town comes out. What a great way to get to know a community."





Each artist is given a microphone when speaking at their site. “It’s really fun for me to listen to the other artists speak about their work,” Swanson says. “Listening to other artists offers another perspective – it’s a wonderful exchange.” Swanson’s sculptures have been placed in 26 states, including 38 locations in Colorado.

Swanson’s current Moab ArTTrails piece is titled *First Sign of Spring* and is meant to advocate for water in the West. “I think as a sculptor, an artist, our responsibility is to interpret culture,” she says. The sculpture is made from glass and raw steel, and interacts with natural sunlight. “Which means the piece will evolve and change,” she says. “It looks different at sunset than at sunrise.” She says she hopes the work will inspire people to start their own conversation regarding water issues.

At the end of the exhibition year, one of the sculptures will be purchased to add to Moab’s permanent collection. “We call them our rotating crops, the yearly harvest being the ‘keeper,’” says Williams Dunton.

The selection committee is comprised of the Duntons, at least one artist, a business owner, plus city and county employees – with public input considered, too. “All year long on our web site (until September 15) people can weigh in,” Michael Ford Dunton says. “Usually it’s emphatic; there’s a clear favorite the community wants to pick.”

“Every year we get people together and discuss which one speaks to us,” Williams Dunton adds. “Does it fit in Moab? Is it safe, sturdy, aesthetically pleasing?”

On the day of ArtStroll, in October, people vote for their favorite candidate for “Best in Show.”



Opposite page: “Wise Spirit Medium,” a stone sculpture by Gedion Nyanhongo, is part of downtown Moab’s ArTTrails current public art exhibit. [Photo by Murice D. Miller] **This page top:** Gedion Nyanhongo with his work, “I See You.” [Photo by Bruce Hucko / Courtesy of Moab ArTTrails] **Bottom:** Reven Marie Swanson’s current Moab ArTTrails piece is titled “First Sign of Spring.” [Photo by Bruce Hucko / Courtesy of Moab ArTTrails]



Clockwise from upper left: "Oracular Oracle," by Moab artist Tim McCallister. [Courtesy of Moab Arts/Moab ArTTrails] "Head Stone (I Am Warrior)," a bronze sculpture on a steel base, by Jacob Harvey. [Photo by Bruce Hucko / Courtesy of Moab ArTTrails] "Dream a Little Dream," a sandstone and steel sculpture by Moab ArTTrails founder Michael Ford Dunton. [Courtesy of Moab ArTTrails] Joan Waters with "Totem: Los Animales." [Photo by Bruce Hucko / Courtesy of Moab ArTTrails] "Cash," by St. George artist Mark Rane. [Photo by Bruce Hucko / Courtesy of Moab ArTTrails] Charlotte Zink with her "Eternal Echoes." [Photo by Bruce Hucko / Courtesy of Moab ArTTrails] Colorado artist Alex Bond with his work, "Under the Flesh." [Photo by Bruce Hucko / Courtesy of Moab ArTTrails]

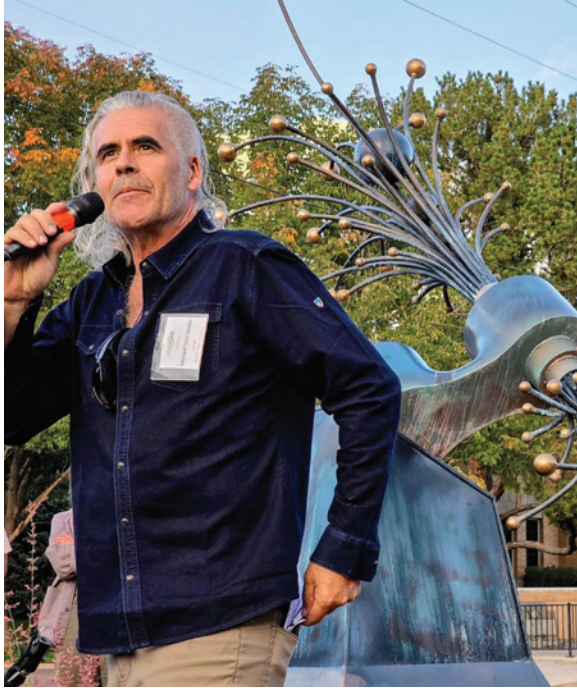

Nyanhongo – who has sculptures exhibited throughout the United States – says he felt “honored” to be voted “Best in Show” in Moab in this current exhibit. “I appreciate it very much,” he says. “It inspires me and paves the way for my inspiration to go deeper and to go even higher.”

All sculptures in the current exhibition are for sale and while artists hope their pieces will be the one purchased to be part of Moab’s permanent collection, the exposure itself is valuable to the artists, says Williams Dunton. “Artists love the program, and we love them, too,” she says. “If it’s a big piece outside of our budget, the exposure might prompt a new hotel or other business to purchase the piece.”

Moab ArTTrails falls under the nonprofit umbrella of the Moab Arts Council. The program is funded by grants from foundations, private donors, merchant sponsors, the city, and in the past, Grand County. Dunton is Moab ArTTrails executive director, and Williams Dunton is artistic director. Since its founding in 2015, Moab ArTTrails has added 14 sculptures to the community’s public permanent collection, which is valued at more than \$119,000.

Each artist receives an honorarium, which basically covers gas money to transport the sculpture,

Dunton says. The recipient of “Best in Show” also receives a \$1,000 cash prize.

The Duntons launched Moab’s public sculpture exhibit by securing private foundational support to gift the Grand County community with his bespoke series of four large stone and steel sculptures titled *Forces at Play* – exhibited on the Moab Crossing at the Colorado Riverway Bike and Pedestrian Bridge.

Dunton adds his own works to the Moab ArTTrails exhibit with a “founder’s contribution” piece each year – he does not take an honorarium, nor is he eligible for an award or purchase.

As executive director he chooses where the newly purchased sculpture is placed each year. “We try to spread the works



Top: Moab ArTTrails co-founders Michael Ford Dunton, left, and Christy Williams Dunton, right. [Courtesy of Moab ArTTrails] **Right:** “Caelum,” a permanent piece since 2020, by Michael Ford Dunton. [Photo by Murice D. Miller]



around,” to public property locations, Dunton says. “We want people who live here to enjoy it.” City and county officials are consulted, too, on deciding where each piece goes.

A similar rotating sculpture exhibition in Grand Junction, Colorado, called “Art on the Corner” inspired Dunton to create Moab’s public art program. “I thought we should have that here,” Dunton says.

“When I think of Grand Junction prior to “Art on the Corner” – it transformed the place – in a good

way,” Williams Dunton says. The late artist Dave Davis founded the Grand Junction program in 1984, in part, to help revitalize the city when it was experiencing an economic downturn in the early 80s.

Grand Junction’s permanent collection includes two of Dunton’s sculptures. He has also sold pieces in California, and other places. His familiarity with public art programs has allowed him to choose the best elements for developing Moab’s own rotating exhibit on a presentational level, and for the artists, he says.

The winner of this year’s Honorable Mention award in Moab went to Simon Saleh, of San Antonio, Texas, for his sculpture titled *Celestial Conversations*. He says the piece was inspired by the night sky – particularly Utah’s night skies. Even though he grew up in a rural area of Texas, Saleh says he never saw such starry nights until he visited Utah’s desert landscapes. The piece, made from steel, is meant to resemble a constellation with a spree of shooting stars, with tails like comets coming from the other end.

His wife Autumn, also a sculptor, noticed Moab’s public art while passing through town on a road trip a few years ago. She collaborated with Saleh on a sculpture that was selected for last year’s Moab ArTTrails exhibition.

Like Swanson and Nyanhongo, the couple’s work has been purchased for various collections nationwide. They also have a contract with the San Antonio Arts and Culture Department to be their “on-call” sculptors, to make large sculptures for that city’s public art program – in collaboration with other Texas artists.

Moab ArTTrails’ selection committee encourages local artists to apply for the yearlong exhibit. “It’s so great to give a check to a local, developing sculptor,” Williams Dunton says. Moab’s permanent collection includes a sculpture by local artist Tim McCallister, titled “Oracular Oracle.”

For a lovely walk in the downtown area, consider a stroll to check out the current exhibit before it gets swapped out for a new crop of sculptures in the fall. For more information or to vote for this year’s “keeper” for the permanent collection, visit: moabarttrails.org. ■



Left: Simon Saleh with his sculpture, “Celestial Conversations.” [Photo by Bruce Hucko / Courtesy of Moab ArTTrails]
Right: “Matriarch” by Steve Grater, a part of Moab’s permanent public art display. [Courtesy of Moab ArTTrails]



7.32 ACRES

of subdividable ranch property with a giant man cave in heart of Moab.
MLS#2123854 | \$2,850,000 | Call Billy



NEW LISTING

NIGHTLY RENTAL NEXT TO GOLF COURSE

Turnkey nightly rental with solar and hot tub next to golf course.
MLS#2131816 | \$879,900 | Call Billy



NEW LISTING

CASTLE VALLEY ARTIST'S HOME

4,500 sq ft climate controlled garage/workshop. Huge deck with outdoor shower. Horse property.
MLS#2140394 | \$990,000 | Call Aaron or Billy



117 FLAT IRON MESA ROAD

7.26 acres in a great location with amazing views. 30 minutes from Moab. Power and fiber optic stubbed to lot.
MLS#1990480 | \$250,000 | Call Aaron or Billy



PRICE DROP! OWNER FINANCING AVAILABLE

RIM VISTA 3 BEDROOM NIGHTLY RENTAL CONDO

Classic investment property that has never been on the nightly rental market. Great shape.
MLS#2138781 | \$580,000 | Call Billy



3 BEDROOM RAMBLER IN MOAB LOCAL'S FAVORITE NEIGHBORHOOD

MLS#2083035
\$485,000 | Call Aaron or Billy



TURNKEY INVESTMENT PROPERTY

3 bed, 2 bath, 1384 sq ft, amenities
MLS#2028947
\$470,000 | Call Aaron or Billy



SOLD!

TOWNHOME NEIGHBORHOOD RENTAL

Clubhouse, pool, 3 bed, 2 bath, garage
MLS#2028954
\$695,000 | Call Aaron or Billy



CHARMING HOME WITH RED ROCK VIEWS

3 bed, 2 bath with great yard. Many updates.
MLS#2113830 | \$399,000 | Call Billy



BILLY SNYDER REALTOR®
812-360-3302 | realbillymoab@gmail.com
realbillymoab.com



AARON DAVIES REALTOR®
aaronrealtormoab@gmail.com | 435-260-8209
moab-property.com

We specialize in resort mortgage lending, jumbos, condo hotels*, conventional, FHA, VA, and Reverse Mortgage*.
Your LOCAL mortgage specialist.



LOVING · LIVING · LENDING



THE MOAB LIFESTYLE!



LISA LUNDQUIST
Senior Loan Officer NMLS# 268664
435.659.1390 | lisal@vfund.com
1389 Center Dr. Suite 200, Office 221, Park City, UT

Veritas Funding NMLS#252108 is an Equal Housing Lender. This is not an offer of credit or commitment to lend. *Veritas Funding brokers these loans.

VERITASFUNDING 

COMBINED COMMERCIAL ACREAGE—3.5 ACRES



MAIN ST. EXCELLENT LOCATION FOR TOURIST OUTFITTER OR DEVELOPMENT

1.92 acres & 197 ft. of Hwy. frontage of C-3 Zoned property with buildings, without business. Adjacent property available, too! **Price: \$ 4,000,000 | MLS#2115620**

PRICE REDUCED BY \$1,000,000

Great Main St. frontage of 209 ft. and 326.4 ft. frontage on 300 N. St.. Business of Grand Tire is not for sale. Seller financing available & preferred. **Only Real Estate Price: \$2,750,000 | MLS#2140139**



LARGE HOME WITH 5 BEDROOMS (3 LEVELS)

Castle Valley home & property with spectacular/unobstructed views in nicer neighborhood w/no junk. Superb location. Great water culinary & irrig. Best dirt in valley. 3356 sq. ft. home cheapest price per sq. ft. Small indoor pool house/sunroom/greenhouse needs little TLC. Fireplace. Small outbuilding with roll-up door. New perimeter fence. Stucco nurture colors. Deck off of upstairs, large deck at main level with views of Castle Rock. **Price: \$850,000 | MLS#2093650**



CASTLE VALLEY SPLENDOR

Lot 437 Rimrock Lane on 6 acres with well and ditch shares. Ready to farm and build. Dynamic views! **Price: \$550,000 | MLS#2122104**

PRICE REDUCED!



LOVELY BRICK HOME ON SPACIOUS CORNER LOT

Close to schools and downtown, custom 5-bed, 3-bath home with hardwood floors, 3,731 sq. ft., 2-car garage. **Price: \$875,000 at just \$234 per sq. ft. MLS#2074164**



LOCATION! LOCATION! LOCATION!

90 S. Main retail with east-facing frontage, afternoon shade, rear parking, prime downtown shopping location. **Price: \$ 1,200,000 | MLS#2096829**

NEW LISTING!



LOVELY CASTLE VALLEY HOME

Stucco exterior and metal roof for easy maintenance. Courtyard stucco wall with textured and colored concrete floor. Lovely flagstone patio on Westerly side. A-1 pristine water well. **Price: \$700,000 | MLS#2148311**



OLD LASAL

Old Airport 7 lots about 4 ac. Each @ **\$30,000/Ac.** W/S.F. Mtn. Views. **MLS#2120018 thru 2120024**



JANIE TUFT

435.260.1572
janietuft@gmail.com
478 S. Mill Creek Dr., Moab
moabpremier.com



SPRING DRAW

Old LaSal Lot 2 & 5. w/S.F. Terms. Mtn. Views
Lot 2 | **Price: \$170,000 | MLS#2120004**
Lot 5 | **Price: \$226,800 | MLS#2120005**



SERVING MOAB

After getting its start as an early agricultural and mining area, Moab is now well known as a gateway to iconic adventure. This visually striking desert region is the place we call home. At Summit Sotheby's International Realty, we don't just sell real estate; we're your neighbors, your fellow adventurers exploring the trails, marveling at sunsets and cherishing every unique quirk that makes Moab enchanting. Our dedication to this town runs deep – whether lending a hand at local events, supporting neighborhood causes, or simply sharing our love for this place, we're here to give back and keep our community thriving.



Lenore Beeson
435.260.2135



Becky Byrd
435.260.2842



Suzanna Feuz
435.260.7634



Susan Shrewsbury
435.260.1479



Gail Wells
435.260.9996



COMMERCIAL

84 West 200 North, Moab
Commercial Building | 1,989 SF | \$1,995,000



3885 S Maynard Lane, Moab
3 BD | 4 BA | 2,957 SF | 5 AC | \$1,750,000



2075 E Munsey Drive, Moab
3 BD | 3 BA | 2,282 SF | \$1,067,000



4170 Vista Antigua Road, Moab
3 BD | 4 BA | 1,992 SF | \$1,050,000



1521 S Highway 191, Moab
Commercial Building | 1,546 SF | \$999,000



420 North 600 West, Moab
4 BD | 3 BA | 2,265 SF | \$948,000



2466 & 2468 E San Jose Road, Moab
3 BD + 2 BA | ADU: 3 BD + 2 BA | 2,496 SF | 0.48 AC | \$785,000



438 Castle Valley Drive, Castle Valley
1 BD | 1 BA | 1,161 SF | \$775,000



57 E Center Street, #1, Moab
2 BD | 2 BA | 1,095 SF | \$749,000



57 E Center Street, #2, Moab
2 BD | 2 BA | 1,095 SF | \$749,000



671 Palisade Drive, Moab
3 BD | 3 BA | 1,700 SF | \$725,000



3686 S Spanish Valley Drive, #01, Moab
3 BD | 2 BA | 1,551 SF | \$679,000

MOAB REAL ESTATE

Continued



3686 S Spanish Valley Drive, #C3, Moab
3 BD | 2 BA | 1,573 SF | \$679,000



1431 & 1443 S Mill Creek Drive, Moab
3 BD | 2 BA | 1,296 SF | \$670,000



3764 Prickly Pear Circle, #5-A6, Moab
3 BD | 3 BA | 1,562 SF | \$620,000



3853 S Red Valley Circle, #11A3, Moab
3 BD | 3 BA | 1,478 SF | \$604,000



55 E Mount Peale Drive, Moab
4 BD | 2 BA | 2,073 SF | \$530,000



1140 San Juan Drive, Moab
3 BD | 2 BA | 1,150 SF | \$525,000



11850 S Highway 191, #B1, Moab
1,800 SF | \$495,000



129 Deer Creek Road, La Sal
3 BD | 2 BA | 1,571 SF | \$485,000



72 East 200 North, Moab
2 BD | 2 BA | 1,149 SF | \$470,000



443 Kane Creek Boulevard, #A104, Moab
1 BD | 1 BA | 608 SF | \$299,500



1371 N Highway 191, Moab
2.75 Acres | \$2,950,000



1880 Skyline Drive
Moab
2.05 Acres | \$850,000



2001 S Highway 191
Moab
1 Acre | \$665,000



1144 N Kayenta Drive
Moab
2.50 Acres | \$530,000



262 Pope Lane
Castle Valley
4.62 Acres | \$415,000



95 Bailey Lane
Castle Valley
6.57 Acres | \$362,290



201 S La Sal Road
La Sal
4 Acres | \$125,000



Parcels 32S24E214800 &
32S24E215400, Monticello
80 Acres | \$80,000



112 E Maddison Avenue
La Sal
3.98 Acres | \$80,000



Legacy Fields Lots
La Sal
3 Lots left | Priced at \$48,500



424 E Secret Cove Court
Moab
Listed at \$1,375,000



1575 South Rocky Road
Moab
Listed at \$295,000



297 Holyoak Lane
Castle Valley
Listed at \$225,000

LA SAL

MOAB

CASTLE VALLEY

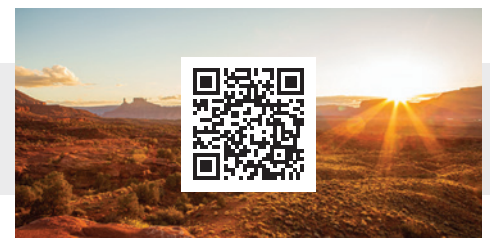

Come Visit Our Office | 59 E Center Street, Moab

Discover the One for You

UNDER CONTRACT



ELEVATED LIVING WITH UNMATCHED VIEWS

2075 E Munsey Drive, Moab

3 BD | 3 BA | 2,282 SF | 2.47 AC | \$1,067,000

PRICE IMPROVEMENT



LIVE AND WORK OPPORTUNITY

1431 & 1443 S Mill Creek Drive, Moab

3 BD | 2 BA | 1,296 SF | 1.08 AC | \$670,000



HILLSIDE HOMESITE WITH STUNNING VIEWS

1144 N Kayenta Drive, Moab

2.50 AC | Sewer/Electricity Available | \$530,000



ENDLESS POSSIBILITIES IN THIS HOME WITH AN ADU

2468 & 2466 E San Jose Road, Moab

3 BD + 2 BA | ADU: 3 BD + 2 BA | 2,496 SF | 0.48 AC | \$785,000

POWER ON PROPERTY



BUSINESS OPPORTUNITY CLOSE TO DOWNTOWN

2001 S Highway 191, Moab

1.00 AC | Zoned Highway Commercial | \$665,000

PRICE IMPROVEMENT



LIVE, WORK AND PLAY IN THE HEART OF MOAB

72 East 200 North, Moab

2 BD | 2 BA | 1,149 SF | 0.2 AC | \$470,000



Susan Shrewsbury

ASSOCIATE BROKER

435.260.1479

susan.shrewsbury@sothebysrealty.com

summitsothebysrealty.com



Lenore Beeson

ASSOCIATE BROKER

435.260.2135

lenore.beeson@sothebysrealty.com

summitsothebysrealty.com

Summit | Sotheby's
INTERNATIONAL REALTY

This material is based upon information that we consider reliable, but because it has been supplied by third parties, we cannot represent that it is accurate or complete, including price, or withdrawal without notice; square footage is an estimate only. Any renderings and illustrative maps are conceptual only and subject to change. ©MMXXVI Sotheby's International Realty Affiliates, Inc. All Rights Reserved. Sotheby's International Realty® is a licensed trademark to Sotheby's International Realty Affiliates, Inc. An Equal Opportunity Company. Each Office Is Independently Owned And Operated. Copyright© Summit Sotheby's International Realty 2026.

TRANSFORM YOUR HOME WITH GIG FAST INTERNET SPEEDS.



*Ultra Fast
Downloads*



*Local
Employees*



*No
Contracts*

SIGN UP TODAY!



(435) 259-8521
EMERYTELCOM.COM



Sue Dalton & Morgan Cook

435-260-8090 | realestate.suedalton@gmail.com
homesinmoab.com



NEW LISTING

STUNNING MODERN LUXURY LIVING WITH ROOFTOP DECK
MLS#2147134 / \$1,419,000
4 bed / 3 bath / 2945 sq ft / Moab



NEW LISTING

TURNKEY NIGHTLY RENTAL IN STUNNING MOAB LOCATION NEAR GOLF COURSE
MLS#2145340 / \$779,000
3 bed / 2 bath / 2088 sq ft



NEW LISTING

LUXURY DESERT LIVING IN THIS BEAUTIFUL HOME NESTLED AMONG TOWERING RED ROCKS
MLS#2143381 / \$1,295,000
4 bed / 4 bath / 2670 sq ft



LOCAL INVESTOR UNIT

GREAT PRICE, 2-BEDROOM, SECOND LEVEL MURPHY FLATS CONDO
MLS#2116070 / \$359,000 / 2 bed / 1 bath / 614 sqft / Moab



NEW LISTING

CUTE RETRO COTTAGE IN GREAT MOAB NEIGHBORHOOD
MLS#2147136 / \$485,000 / 3 bed / 1 bath / 1178 sq ft



LOCAL INVESTOR UNIT

GROUND LEVEL CONDO CLOSE TO DOWNTOWN MOAB
MLS#2068609 / \$259,000 / 1 bed / 1 bath / 430 sq ft



BEAUTIFULLY REMODELED HOME IN EXCELLENT NEIGHBORHOOD
MLS#2131766 / \$695,000 / 3 bed / 3 bath / 2633 sq ft



PRICE REDUCTION

IN TOWN BUILDING LOT WITH PANORAMIC VIEWS
MLS#2107197 / \$255,000
0.49 acres / Zoned R-2 / Utilities ready to go / Moab



CHARMER IN THE HEART OF OLD TOWN MOAB
MLS#2124797 / \$495,000 / 3 bed / 1 bath / 1207 sq ft



INVESTMENT! HOUSE & TRAILER PARK
6 trailer spaces with 4 owned trailers / 1,231 sq ft house
1 acre lot / Located 2 blocks from Moab Main St.
MLS#2097008 / \$949,000



EXTREME PRICE REDUCTION!!

PREMIUM COMMERCIAL LOT JUST OFF MOAB MAIN STREET
MLS#2032413 / \$850,000 / 0.6 acres
Zoned C4 / Next to McDonald's



MULTI-UNIT NIGHTLY RENTAL

HOME + NIGHTLY RENTAL +TRAILER PARKING + LARGE GARAGE
MLS#2114536 / \$859,000
7 bed / 4 bath / 4774 sq ft

Kristie Whipple & Tiffanie Whipple



(435) 260-1020 | kristiesellsmoab@gmail.com

kristiesellsmoab.com



NEW LISTING

SECOND STORY UNIT

MLS#2133960 / \$290,000
1 bed / 1 bath / 500 sq ft / Moab



NEW LISTING—RANCHETTE ON 6 ACRES

BARN, SOLAR, WELL, ORCHARD, FENCED PASTURE

MLS#2143654 / \$569,900
2 bed / 2 bath / 1782 sq ft / Monticello



NEW PRICE

MAIN FLOOR UNIT

MLS#2069784 / \$269,000
1 bed / 1 bath / 500 sq ft / Moab



NEW PRICE

UPDATED FLOORING & PRIVATE COURTYARD

MLS#2136450 / \$469,000
2 bed / 2 bath / 1185 sqft / Moab



NEW PRICE

ONE ACRE ESTATE WITH SHOP

MLS#2091526 / \$1,035,000
4 bed / 3 bath / 4072 sq ft / Moab



NEW PRICE

UNIQUE PROPERTY WITH STREAM

MLS#2118875 / \$599,000
4 bed / 2 bath / 2242 sq ft / Moab



REMODELED

MLS#2118681 / \$399,000
3 bed / 2 bath / 1957 sq ft / Monticello



ALSO FOR RENT

CHARMING, UPDATED HOME

MLS#1984088 / \$319,900
3 bed / 1 bath / 1440 sq ft / Monticello



CUSTOM HOME ON 6.49 ACRES

MLS#2125953 / \$949,000
1 oversized master / 2 bath / Monticello

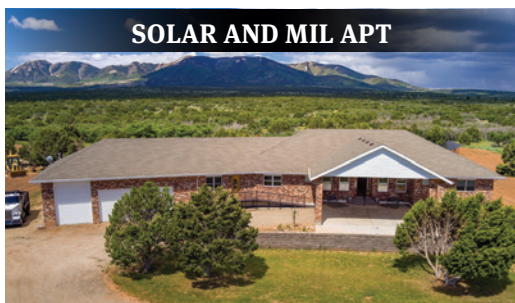

SOLAR AND MIL APT

LUXURY HOME ON 24.6 ACRES
MLS#1885276 / \$1,350,000
4 bed / 3 bath / 5285 sq ft / Monticello



COMMERCIAL

LAUNDROMAT EQUIPMENT INCLUDED

MLS#1998344 / \$375,000
.41 acres / 1536 sq ft / Monticello



NEW LISTING

.22 ACRES
MLS#2145419 / \$269,000
Moab

A PASSION FOR MOAB'S HISTORY

Blaine Reniger wants to share the region's unique stories with locals and visitors

Written by Rachel Fixsen

“History is all around us,” says Blaine Reniger, the Moab local behind History Moab. “Our history here is literally engraved in stone on our walls. Our history here lies within the ruins that are out in the middle of a desert where cowboys camped. It’s on all these buildings on Main Street. It is just in the very fabric of what Moab is.”



Reniger, a North Carolina native, made a home in Moab and channeled a personal love for history into a mission to preserve and share Moab's past. As a four-wheel driving guide, he shares local history with visitors; he also hosts a history podcast and has developed a class to educate Moab area guides of all kinds on local history.

"You can't look anywhere and not see history here," he says. "I think that's so beautiful. So my main goal and mission is just to get people to see what I'm seeing."

A lifelong love

Reniger says he's loved history since he was a kid. He also remembers watching Western movies and TV shows with his dad, being fascinated by cowboy and Native American cultures, and falling in love with the scenery of the West. One of his favorites was 1993's *Geronimo*, which was filmed in large part in locations around Moab: Professor Valley, Onion Creek, and Dead Horse Point.

When Reniger first came to Moab eight years ago he was living in his van, moving from place to place and studying history. On his first day in town, he had a strange, unshakeable feeling of being at home. Over a campfire in the La Sals, he made a deal with himself, or with fate: if he was meant to stay in Moab, he would get hired at the first place he applied. He was hired at NAVTEC Expeditions, a local guiding company and decided to put down roots. Today he's the operations manager at NAVTEC.

History Moab: On Air

Reniger first got involved at local community radio station KZMU as the subject of an "audio portrait" about alternative lifestyles in Moab (he was living in his van at the time). Being on the air gave him an idea.

"At this point I'm already super-deep into history," he remembers. "I'm reading every book I can get my hands on, I'm talking to older folks, and I'm realizing that there's a lot of people here who remember the uranium days, who remember the cowboy days, and who remember the start of tourism out here." So he pitched a history podcast to KZMU, and got an hour-long slot once a month for what he called the History Hour.

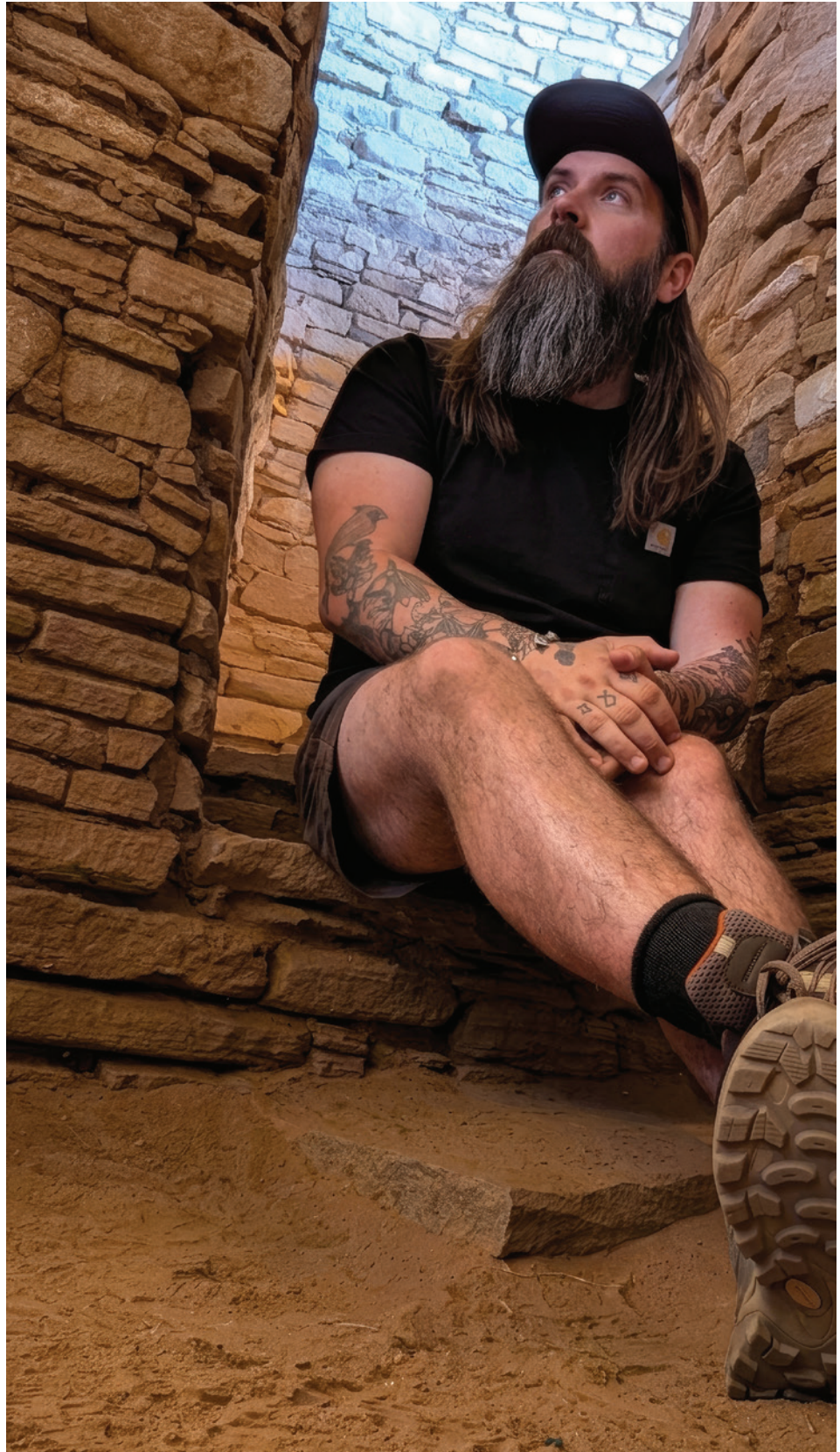

Opposite page: John W. "Doc" Williams is often referenced by History Moab's Blaine Reniger. Williams was hired in 1896 as the local doctor, but, among other skills, was also a cowboy, boatman, businessman and early advocate for public lands. [Courtesy of Moab Museum]

This page: Blaine Reniger [Courtesy photo]



He interviewed guests, including history experts like river runner and historian Roy Webb, local legends like guiding pioneer and rockhound Lin Ottinger, or descendants of important figures in Moab history, like the children of the “Father of Canyonlands” Bates Wilson. If he didn’t have a guest lined up, he researched a local topic—for example, Butch Cassidy, the famous outlaw—and shared what he learned. He looks for concrete sources when he’s researching, he says—things like artifacts, photographs, historical documents, or contemporary journal entries, corroborated by other sources describing an event.

“This show is huge in that it captures the stories of an aging generation of living legends while they’re still with us,” says KZMU Executive Director Jenna Whetzel. “Blaine has created a historical archive and

“You can’t
look anywhere
and not
see history here.
I think that’s so
beautiful.”



an audio time machine that lets us all bear witness to how the region has changed over the years.”

With more on his plate now than when he first started the show, Reniger has cut back to just half-hour episodes, and the podcast is now called History Moab: On Air, but otherwise the format is the same. Past episodes are archived on the KZMU website.

History 101 for Guides

In 2023, Reniger had another idea: creating a curriculum to educate local guides on local history. Out on the trail, he had started to overhear guides telling stories or interpreting artifacts or petroglyphs, and realized that a lot of what was being presented was incorrect.

“To me it sounded like someone did their research a really long time ago, and

Left: Reniger says that his earliest fascination with the Moab area came from time spent with his dad watching old Western films like *Rio Grande*, much of which was filmed in the region. [Courtesy of Moab Museum] **Right:** Reniger hosts a long-running radio show on Moab’s KZMU called “History Moab: On Air.” [Courtesy photo]

it's like the game of telephone, how the story changes with each person," he says. He wanted to see accurate information being passed on.

"Our whole region is so sacred," he says. "If guides are out there telling false narratives, and incorrect interpretation, we're not doing this place any justice (and we're not doing our tourists any justice.)"

He contacted the Moab Museum about developing a course, and he and Mary Langworthy, formerly of the Moab Museum, put it together. Companies could book a two-hour course at the museum and send their staff to learn both a foundation of local history in general, and also a more detailed look at a specific niche as requested by the company—for example, history of Indigenous people, the national parks, or the river.

"The curriculum has developed a lot around questions that come up in training," says Megan Vickery, programs director at the Moab Museum, who has taken over the museum's role in the History 101 class since Langworthy has moved on.

"What I understand to be interesting about the river, or what is in our collection, doesn't always line up perfectly with what questions guides are getting from clients or the lore that has been passed down in any particular company," she explains. For example, tourists on river trips often ask about old movie sets visible from the water, or about remnants from a survey for a potential dam project that never materialized. Museum staff might not have thought to address those things specifically if guides didn't ask about them.

Twice a year, the History 101 course is open to community members or visitors, who can submit questions ahead of time. Some of those questions are things Vickery says she would never have thought to research, but can yield interesting facts. One participant asked about how and when road names had changed over time, prompting her to consider the significance of names and how they shape our perspective.

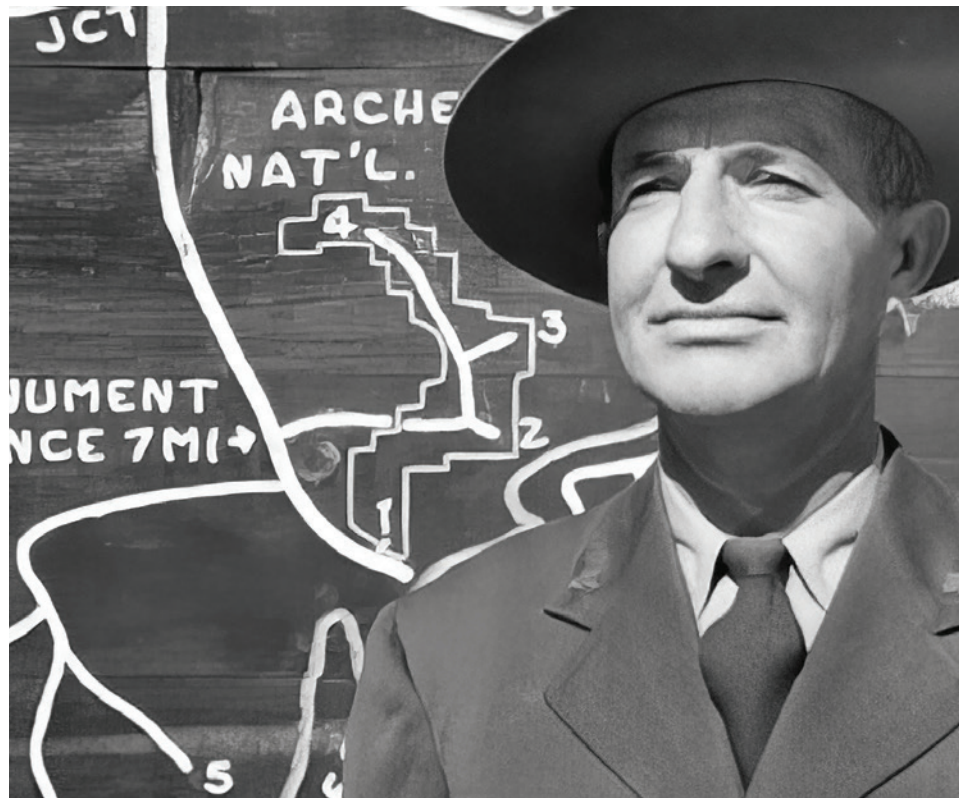

Top: Bates Wilson was the superintendent of Arches National Monument from 1949 to 1972 and of Canyonlands National Park from 1964 to 1972. Wilson is remembered as the "Father of Canyonlands" because of his dedication to making it a national park. [Courtesy of Moab Museum] **Bottom:** The "Fort Worth Five Photograph." Front row left to right: Harry A. Longabaugh, alias the Sundance Kid; Ben Kilpatrick, alias the Tall Texan; Robert Leroy Parker, alias Butch Cassidy. Standing: Will Carver & Harvey Logan, alias Kid Curry; Fort Worth, Texas, 1900. [Wikimedia Commons/Studio of John Schwartz]



“Moab can answer to so many interests,” Vickery says. “We’ve got a really cool and diverse set of stories here—there’s kind of something for everyone.”

Only a couple of companies signed up for the class the first year, but it has been growing and Reniger estimates they taught close to 100 people last year.

Kathryn Blitz is the owner of local guide company Wild West Voyages, and her staff took the course a couple of years ago. She loved it.

“It was thorough, it was informative, it was interesting, it stirred curiosity (and) further research on the part of our guides,” she says. “I just can’t say enough good things about it.”

The museum gave Wild West staff a notebook of photocopied resources, and Blitz says she still refers to it sometimes.



One of her favorite items there is a transcript of an interview with Essie White, who lived on the ranch that is now Red Cliffs Lodge.

“At the time when she was raising kids mostly by herself out there, she didn’t have running water or electricity or easy access to town,” Blitz says. “It was a hard life.” When Blitz first became a guide, she learned more about Essie’s husband, George White, and his role in Moab’s film industry. She enjoyed reading that first-hand account of a woman’s experience, a part of history that often doesn’t receive much emphasis.

Blitz is a retired teacher, and her company also offers history tours of Moab.

“The educational component of our tours is paramount,” she says. “A program like this, specifically for guides, really elevates the guide profession here in town.”

What’s next for History Moab

In addition to the radio show and the guide classes, Reniger gives lectures once a year at the Moab Information Center. They’re open to the public. He’s also been asked to present to school groups and for the Moab Office of Tourism. Reniger anticipates getting busier—giving more talks, partnering with more organizations, and potentially hiring staff and registering as a nonprofit.

For the past four years, Reniger has also been working on a book.

“It started off as an idea of just having a timeline for guides to just throw in their backpack,” he says. He wanted it to cover all of human history in the region, from the Paleo and Archaic periods up to the present, in chronological order. As he worked, he realized it was going to be more than just a lightweight timeline.

Left: Born in 1905, Essie White was the daughter of early Moab settlers George Amasa and Julia Larsen. Essie and her husband, George White, raised their family and livestock at their ranch (now Red Cliffs Lodge) along the Colorado River. With support from the Whites, the ranch became a popular location for filming Hollywood Westerns. [Courtesy of Moab Museum] **Right:** Blaine Reniger interpreting an area petroglyph panel. [Courtesy photo]

"It's just turned into a full-on book," he says. "I've got eight chapters and I would like to have about five or six more."

He also plans to include lots of photos gleaned from personal collections and historical archives to which he's been granted access. He's still looking for a publisher, and meanwhile, drafting those other chapters.

Making history relatable

Sometimes Reniger meets people who say they don't like history. He tries to change their minds by telling them funny stories, or details about individual people.

"Moab is full of interesting people in our history, who've lived differently, who've acted differently, who went beyond the bounds of what people would think," Reniger says. True stories about those individuals, their personalities, challenges, and triumphs, help people relate to the past, he says.

One local character Reniger talks about is Jack "the goat man" Holley, who moved to Moab in the 1930s and lived in a shack with his goats and dogs near the present-day Colorado River Bridge just north of town.

"I don't care who you are, if you love history or not, you always love a good story about an interesting person," Reniger says. If he's talking to river runners, he might bring up the Kolb brothers, who boated the Green and Colorado rivers from Wyoming to California in 1911.

Two of his own favorite local historical figures are Doctor J. W. Williams and Bates Wilson. Both were instrumental in establishing Arches and Canyonlands national parks.

"If it wasn't for Bates Wilson and Doc Williams, we wouldn't have any of this out here at all," Reniger says. "We would have no tourism. We would have no parks."

Through their passion and enthusiasm, Wilson and Williams secured protections, enhanced access, and promoted the parks. Reniger considers them role models.

"I want people to see my passion and my enthusiasm, and I want it to be infectious," he says. "And I want to make a difference simply just by having those same characteristics that those men had." ■



Top and bottom right: In 1911, daring river runners Ellsworth and Emery Kolb retraced the journey of Major John Wesley Powell, boating the Green and Colorado rivers from Wyoming to California. [Courtesy Northern Arizona University/Cline Archive] **Bottom left:** Among Moab's fascinating past inhabitants that Reniger sometimes talks about is Jack "the goat man" Holley, who moved to the area in the 1930s and lived in a shack with his goats and dogs near the present-day Colorado River Bridge north of town. [Courtesy of Charles W. Cushman Collection at Indiana University]

LOCAL BY CHOICE BUILT ON RELATIONSHIPS

We believe real estate should strengthen the communities it serves. We believe relationships matter more than logos. We believe trust is earned, not branded. We believe expertise comes from experience, not distance.

Wells Land & Real Estate exists to serve Moab with integrity, clarity, and deep local commitment because this place, deserves nothing less.

2720 EAST BENCH ROAD, MOAB

PRICE IMPROVEMENT

\$1,295,000 | 1.53 Acres | 3 BD | 3BA | 3,687 SF

WELLS

LAND • REAL ESTATE



CURTIS WELLS

PRINCIPAL | MOAB, UT

📞 435.599.7309

✉️ CURTIS@WELLSLRE.COM

🌐 WELLSLRE.COM

DEEP ROOTS, REAL EXPERTISE.



Lower Two Mile Rd, Old La Sal
\$2,800,000
105 Acres | Homesteader's Dream



599 S Hideaway Cv, Monticello
\$795,000
24.4 Acres | 4 BD | 3 BA | 2,526 SF



1285 Arnel Lane, Moab
\$1,350,000
.83 Acres | Rare Lodging Asset



McKnight Commercial Subdivision
\$1,900,000 Starting
2-3 Acres



Mountain Homes Subdivision
\$100,000 Starting Price
Old La Sal



Moonrise at Wilson Arch
New Vacation Rental Development

TRUSTED MORTGAGE LENDER

VA • FHA • USDA • CONVENTIONAL • JUMBO
REVERSE • PURCHASE • REFINANCE

Call today to find out what
the right lender can do for you.

(435) 259-0259



Rarni Schultz

Branch Manager | NMLS #414150

(435) 210-0744

rschultz@primeres.com

285 South 400 East Suite 212 | Moab, Utah 84532

Britt Barton

Division Manager | NMLS #297406

(435) 678-3535

bbarton@primeres.com

356 South Main Street | Blanding, UT 84511



PRMI

Primary Residential
Mortgage, Inc.



← **APPLY HERE**

PRMI NMLS ID: 3094. PRMI is an Equal Housing Lender. **DISCLAIMER:** Some products and services may not be available in all states. Credit and collateral are subject to approval. Terms and conditions apply. This is not a commitment to lend. Programs, rates, terms and conditions are subject to change without notice. Utah Division of Real Estate #5489480. Regulated by the Division of Real Estate.





Have your business seen first by visitors!
 This flat, 2.39 acre parcel is located just as you cross the Colorado River bridge into Moab. Zoned Resort Commercial, it offers a wide variety of uses.
 MLS#2059924 | 2059925 | \$2,750,000



High visibility Main Street location
 Three parcels - zoned C3, RA1 and RA3 - for a total of 11.66 acres. Limitless possibilities for commercial/residential development.
 MLS#1896157 | 1896150 | \$3,900,000



A great place to start your home ownership journey!
 In town location with assumable VA loan (3.375% interest) or CRA loan (low down payment & no mortgage insurance). MLS#2127829 | \$487,000



3453 Lemon Lane

Quiet, peaceful location—but still close to town.
 3 bedroom, 2 bath with a covered back deck - perfect for relaxing and enjoying the amazing views of the La Sal mountains and the Red Rocks.
 MLS#2146925 | \$495,000



Rare opportunity to own this secluded lot!
 360° views of Behind the Rocks Wilderness Study Area and the La Sal Mountains. A place where tranquility, breathtaking views and star-filled nights come together. Make your dream home or getaway a reality.
 MLS#2134355 | \$325,000



Don't miss the opportunity to own this little slice of paradise!
 Stunning mountain views with a newer modular home on a large lot in La Sal. Bring your horses/livestock, plant your own gardens! No CC&R's.
 MLS#2080932 | \$365,000



The gateway to Moab

Join the likes of the Moab Giants, The Red Earth Venue and the Rocky Mountaineer at the gateway to Moab! This unique lot is located in a high traffic area and has excellent visibility from both Hwy 191 and SR 313.
 MLS#2087724 | \$199,000



Commercial lot downtown

This C3 lot is one block from Main Street. Some (but not all) uses include: restaurants, bars, food truck parks, ground floor employee housing in conjunction with a commercial use, offices, retail, etc. Flat, vacant and ready to build.
 MLS# 2069487 | 2069488 | \$549,000

**Truly Local, Truly Expert –
 On your side from day one.**



Danette Johnson
 REALTOR®
 435-260-0130
 danetteinmoab@aol.com



(435) 259.7870
 301 S 400 East | Moab, Utah 84532
www.moabrealty.com



GRAND AREA MENTORING

MOAB'S HERO HEADQUARTERS!

Join the team making Moab a happier, healthier community.

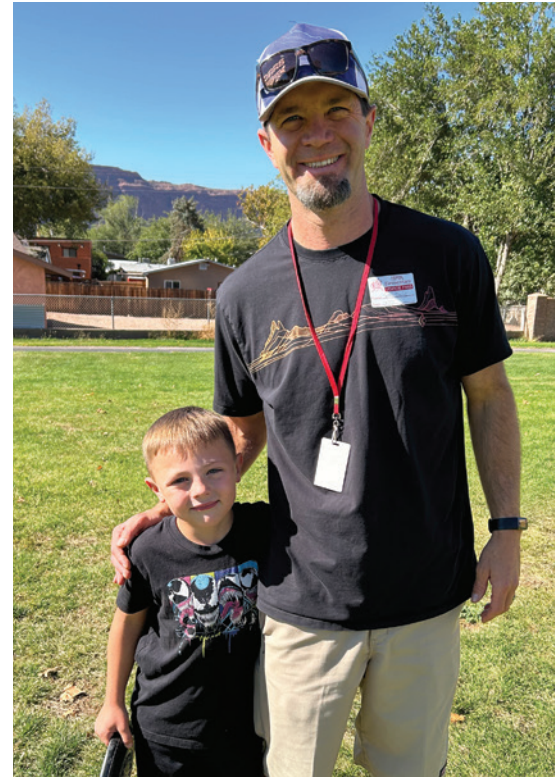

89%

of mentored youth report greater confidence.

100%

of teachers agree that most mentored youth demonstrate better social skills.

84%

get along better with others

“Mentoring is why I come to school.” –MOAB MENTEE

“From the first time I saw her, we have fun, even when we’re different. She’s 80 and I’m 6.” –MOAB MENTEE

“You’ve been helping me feel happy inside. If I need anything, I know I could ask you.” –MOAB MENTEE

“Grand Area Mentoring is one of Moab’s strongest and most valuable resources and systems of support.” –GCSD TEACHER

Supporters are invited to become volunteers or to make a monetary contribution so Grand Area Mentoring can support Moab’s promising youth.

Call or email to learn more: (435) 260-9646 • grandareamentoring@gmail.com

264 South 400 East | Moab, UT 84532 | Join us on FACEBOOK!

grandmentoring.org

CARE WHEN YOU NEED IT MOST

Every day, right here in Moab



EMERGENCY DEPARTMENT

OPEN EVERY DAY

24/7 CARE FOR SERIOUS & LIFE-THREATENING CONDITIONS



URGENT CARE

OPEN EVERY DAY – NO APPOINTMENT NEEDED

MON - FRI, 10AM - 8PM | SAT & SUN, 10AM - 6PM



PHARMACY

OPEN EVERY DAY – WITH CONVENIENT DRIVE-THRU

MON - SAT, 10AM - 2PM & 2:30PM - 8PM | SUN 3PM - 7PM



MOAB REGIONAL HOSPITAL



YOUR TRUSTED LOCAL WINDOW CONTRACTOR AND RETAILER



**REPLACEMENT WINDOWS & INSTALLATION | NEW CONSTRUCTION WINDOWS & INSTALLATION
DIRECT TO CONSUMER/CONTRACTOR SALES**



OUR MISSION: The window business has had a hole in the system for a long time. Our goal was to change that. No gimmicks, just high quality windows at a reasonable price. We can find the window that fits your needs, desired look, and budget. When ordering a window with most companies, it often goes through multiple retailers or dealers before being manufactured, which means a lot more markup, and a lot more room for error.

As a general contractor, I saw that orders were being delivered incorrectly, and the pricing for some of the brands was exorbitant. I set out to solve this issue for our clients. So here we are offering windows unlike anyone else.

Nichols Windows is a branch of Nichols Remodeling & Construction — a trusted and successful construction company in Price, Utah.

Jackson Nichols, Owner and General Contractor | 435-630-8687 | Financing Available | [NicholsRC.com](https://nicholsrc.com) | 





**Central Utah
INSURANCE AGENCY**

Your hometown independent insurance agency.
Serving YOU since 1962.

AUTO • HOME • HEALTH • LIFE • BUSINESS



880 South Main Street • 435.259.5981 • insuremoab.com

TREADLITESTUDIO.COM 435-327-0370



**TREADLITE
STUDIO**

DESIGN | BUILD | CONSULT

**House cleaning,
garden cleanup,
home checks,
plant care &
cat care**



**Hand and Heart
GARDENING, LLC**

Call Julia 435.210.1317

licensed and insured
great local references

**LOWRIDING IN THE AMERICAN
SOUTHWEST**

Commemorating America's Semiquincentennial
Opens April 24, 2026



For information on events, exhibitions,
programs, membership, virtual happenings,
and more, visit our website:

MOABMUSEUM.ORG

Tuesday - Saturday 9am -5pm

435-259-7985 • 118 E. Center Street, Moab, UT

Welcome to Moab!

DIRECTORY OF OFTEN-REQUESTED INFORMATION

Area code 435 unless noted otherwise



Photo by AZCat / iStock.com

MOAB CITY NUMBERS

All Emergencies: 9-1-1
Police: 259-8938
Fire Dept.: 259-5557
City Hall: 259-5121
Post Office: 259-7427
Library: 259-1111
Chamber of Commerce: 259-7814
City Planning Dept.: 259-5129
City Recreation Dept.: 259-2255

GRAND COUNTY NUMBERS

Sheriff: 259-8115
Grand County School District: 259-5317
County Clerk (Voter Reg.): 259-1321
County Assessor: 259-1327
County Administrator's Office: 259-1346
County Recorder: 259-1332
County Treasurer: 259-1338
Building/Development Permits: 259-1343
Building Inspector: 259-1344
Economic Development: 259-1248
Travel Council: 259-1370
Recycling Center: 259-8640

UTILITY CONTACTS

City of Moab: 259-5121
Enbridge Gas: 719-2491 or 719-2490
Rocky Mountain Power: 888-221-7070
Grand Water & Sewer: 259-8121
Moab City Public Works: 259-7485
Monument Waste Services: 259-6314 / 7585
Frontier: 800-921-8101
Emery Telcom: 259-8521
Amerigas Propane: 259-6756

MEDICAL AND DENTAL CONTACTS

Moab Regional Hospital: 719-3500
Moab Dental Health Center: 259-5378
Merrill Hugentobler, DDS: 259-7418
Moab Regional Health Center: 719-5500

TRANSPORTATION

Canyonlands Regional Airport: 259-4849
Contour Airlines 888-332-6686
Redtail Air: 259-7421
Amtrak/Green River: 800-872-7245
Greyhound Bus/Green River: 564-3421
Canyonlands Car & Jeep Rental 259-4413

QUICK FACTS:

Elevation: 4,026 ft
Settled: 1878
Mayor: Joette Langianese
Population: Moab 5,268 (2019),
Grand County 9,640 (2019)
Highest point in La Sal Mountains:
Mount Peale, 12,721 ft
Climate: Midsummer average high/low: 99F/65F,
Midwinter average high/low: 43F/20F
Average annual precipitation in Moab: 9 inches
Speed limit in town: 25MPH (15MPH for OHVs)
Driving distance in miles to Salt Lake City: 233,
Denver: 354, **Las Vegas:** 458

Moab Toy Taxi: 260-7222
Enterprise Car Rental: 259-8505
Salt Lake Express 208-656 8824

UTAH STATE NUMBERS

Motor Vehicle Div: 259-3743
Drivers License Div: 259-3743
Hwy Patrol: 259-5441
Health Dept: 259-5602
Moab Employment Center: 719-2600
District Court: 259-1349

NAT'L & STATE PARKS & PUBLIC LANDS

Arches Nat'l Park: 719-2299
Canyonlands Nat'l Park: 719-2100
Dead Horse Point State Park: 259-2614
Bureau of Land Management: 259-2100
U.S Forest Service: 259-7155
To Report a Wildfire: 259-1850
Poaching Hotline: 800-662-3337

CITY INFO:

Moab City: 259-5121
www.moabcity.org
Monticello: 587-2271
www.monticelloutah.org
Blanding: 678-2791
www.blandingutah.org

GRAND COUNTY

Building Inspector: 259-1344
Economic Development: 259-1248
Water and Sewer: 259-8121
Sanitarian: 259-5602
Assessor: 259-1327
www.grandcountyutah.net

SAN JUAN COUNTY

Building Inspector: 587-3225
Economic Development: 587-3235 x5006
Water and Sewer: 587-3221
Sanitarian: 587-2021
Assessor: 587-3221

INSURANCE COMPANIES

Central Utah Insurance: 259-5981
Markle Insurance: 259-5241
State Farm Insurance: 259-5161

LENDERS

Fidelity Mortgage: 719-4100
www.fidelitymortgage.com
Primary Residential Mortgage: 259-0259
www.primaryresidentialmortgage.com
Eastern Utah Comm. Credit Union: 259-8200
www.euccu.com
Mountain America Credit Union: 259-1500
www.macu.com
Zion's Bank: 259-5961
www.zionsbank.com
Wells Fargo Bank: 719-2700
www.wellsfargo.com

CONTRACTORS

Tekton, LLC 260-0871
Henderson 259-4111
Triple J 259-9988
Moab Construction 259-8529
Delray 259-0515
J2 Builders 220-0089
SA Construction 260-9674
TWS 200-5570
Jude Tuft 719-5082
EcoLogic 210-0241
Nichols Windows 630-8687

Moab Area Real Estate Magazine does not guarantee the accuracy of information presented above. To have information updated, removed or added, email andrewmirrington@gmail.com.

LIONSBACK RESORT



MOAB, UTAH

IMMERSED
IN
NATURAL WONDER



scan to view
the digital brochure



Designed to blend in with its natural landscape, Lionsback Resort offers an unrivaled launchpad for all the adventure, exploration and relaxation Moab has to offer, all while treading lightly on the land.

Introducing the Resort Pool, a refreshing desert haven complete with spa and cold plunge, so you can relax, recharge, and enjoy. Opening soon.

MODEL OPEN

Call for an Appointment.
Now Offering 2 & 3 Bedroom Casitas and the
4 Bedroom Spire. Furnished & Move-in Ready.
Short-Term Rental Zoning.

435.260.8240

LIONSBACKRESORT.COM



RACHEL MOODY TEAM
MOAB REAL ESTATE CO.

This information is subject to the legal disclaimers which can be found in full at lionsbackresort.com ©2026 BHH Affiliates, LLC. An independently owned and operated franchisee of BHH Affiliates, LLC. Berkshire Hathaway HomeServices and the Berkshire Hathaway HomeServices symbol are registered service marks of Columbia Insurance Company, a Berkshire Hathaway affiliate. Equal Housing Opportunity. Information not verified or guaranteed, and subject to change without notice.

BERKSHIRE
HATHAWAY
HOMESERVICES

UTAH
PROPERTIES

Don't Leave The Adventure Behind!

Find your dream home in Moab today!



Use our website to find houses, condos, townhomes, commercial properties, land, and rentals! Updated within minutes after properties are listed and available to you faster than any other property website.

 **Utah Real Estate.com**